

**TRIBAL  
DISEASE AND INVASIVE SPECIES  
MANAGEMENT AREAS**

**Aakoziwin miinawaa Bakaan Ingoji  
Ga-Ondaadag Endanakamagak**



Updated: July 19, 2019 (new sampling locations)

Great Lakes Indian Fish & Wildlife Commission  
P. O. Box 9, Odanah, WI 54861  
(715) 682-6619  
[www.glifwc.org](http://www.glifwc.org)

## INTRODUCTION

The intent of this publication is to provide a readily accessible means of identifying and locating tribally-designated Disease and Invasive Species Management Areas, known in Ojibwemowin as “Aakoziwin miinawaa Bakaan Ingoji Ga-Ondaadag Endanakamagak.” So-called invasive species, known in Ojibwemowin as “bakaan ingoji ga-ondaadag” (translated to: that which comes from somewhere else and resides here now) are plants and animals that have immigrated to the Ceded Territories from other locations. Without intending to, their translocation can impact local and/or regional plant and animal communities, and thereby impact the ability of the Anishinaabe to engage in traditional cultural activities. Diseases, or “aakoziwin” (translated to disease or sickness), can similarly impact plant, animal and Anishinaabe communities. The Tribes have enacted amendments to the Off-Reservation Conservation Codes applicable to the 1837 and 1842 Ceded Territories to address certain diseases and/or invasive species. The following sections provide a summary of the applicable regulations regarding diseases and invasive species, a description of where they apply (including maps) and other information.

## **A. Tribal CWD Management**

The CWD Management Areas identified in this document are areas in which the potential for a member to kill a deer carrying chronic wasting disease (CWD) is increased. Restrictions on the transportation of deer carcasses killed within these areas, and additional precautions, are necessary to safeguard wildlife and human health. Tribal CWD Management Area boundaries are recommended on a case-by-case basis by the Intertribal CWD working group and approved by the Voigt Intertribal Task Force. The Tribal CWD Management Area is defined as the area encompassed by tribal wildlife management units 37, 42, 52, and portions of 38 within Oneida County in Wisconsin (Figure 1).

The following regulations, contained within Chapter 6 of the Tribal Off-Reservation Conservation Codes (Voigt Model Code), apply to deer killed within a CWD Management Area:

### **6.25 Transportation of Deer Carcasses from a CWD Management Area.**

(1) No member shall transport the carcass of any deer killed within a tribally-designated CWD Management Area outside of the tribally designated CWD Management Area except as described in subsection (2).

(2) A tribal member may transport the following items outside of tribally-designated CWD Management Area:

- (a) Deer meat that is boned out, cut and wrapped, with no parts of the spinal column or head attached or included;
- (b) Quarters of a deer carcass, or other portions of meat, with no part of the spinal column or head attached or included;
- (c) Deer hides with no heads attached;
- (d) Deer antlers, or clean (no brain tissue attached) skull plates with antlers attached; and
- (e) Finished deer taxidermy mounts.

### **6.26 Deer Registration for a CWD Management Area.**

No member shall register a deer killed within a tribally-designated CWD Management Area except via remote registration.

### **6.27 Disposal of a Deer Carcasses within a CWD Management Area.**

No member shall dispose of any carcass of a deer killed within a tribally-designated

CWD Management Area except at the site of kill, or within a licensed landfill (Figure 2), or designated deer carcass collection site, located within the tribally-designated CWD Management Area.

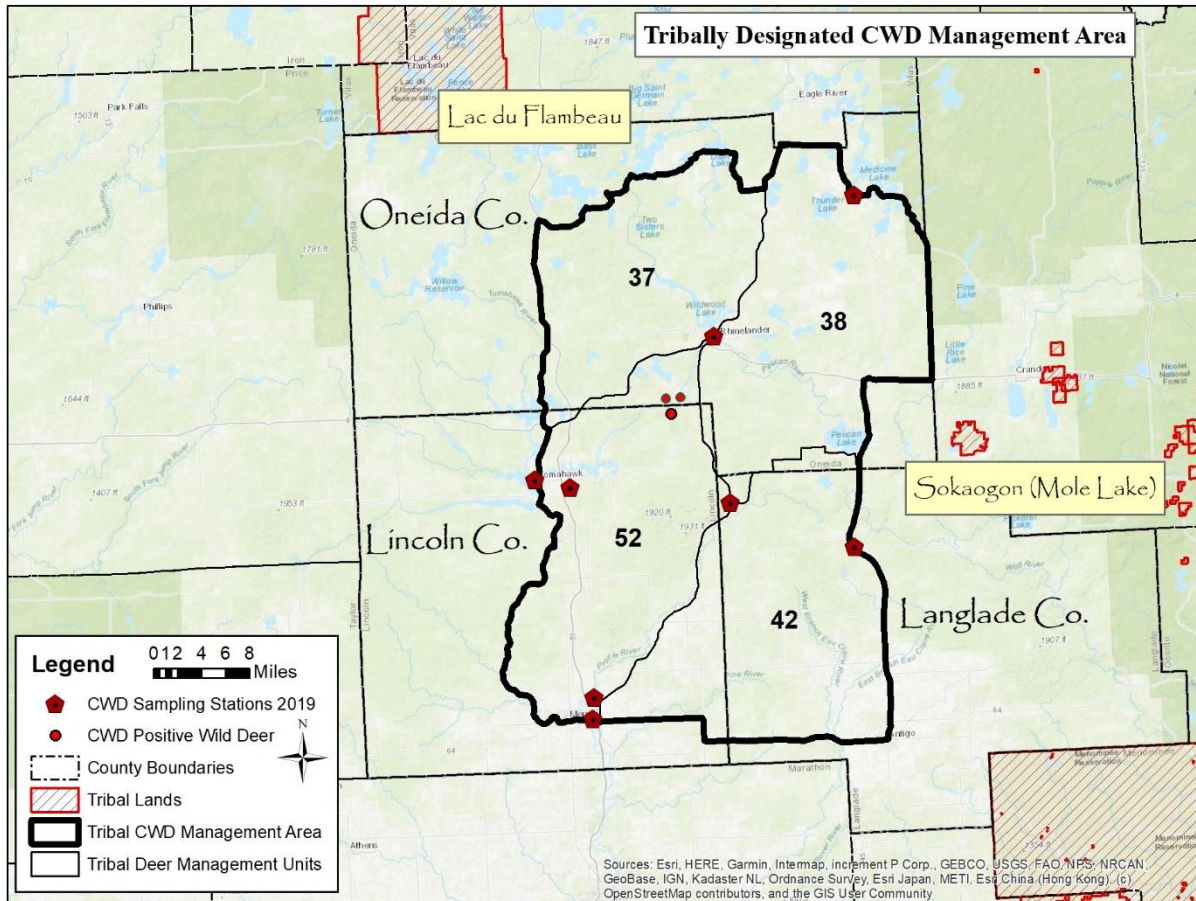

**Figure 1.** Tribally designated CWD Management Area consisting of Tribal Wildlife Management Units 37, 42, 52, and portions of unit 38 within Oneida County, WI.

Deer carcass landfill disposal options within the tribally-designated CWD management area:

Oneida County Landfill  
7450 County Hwy K  
Rhineland, WI 54501  
(about 7.5 miles west of the WDNR service station in Rhineland)

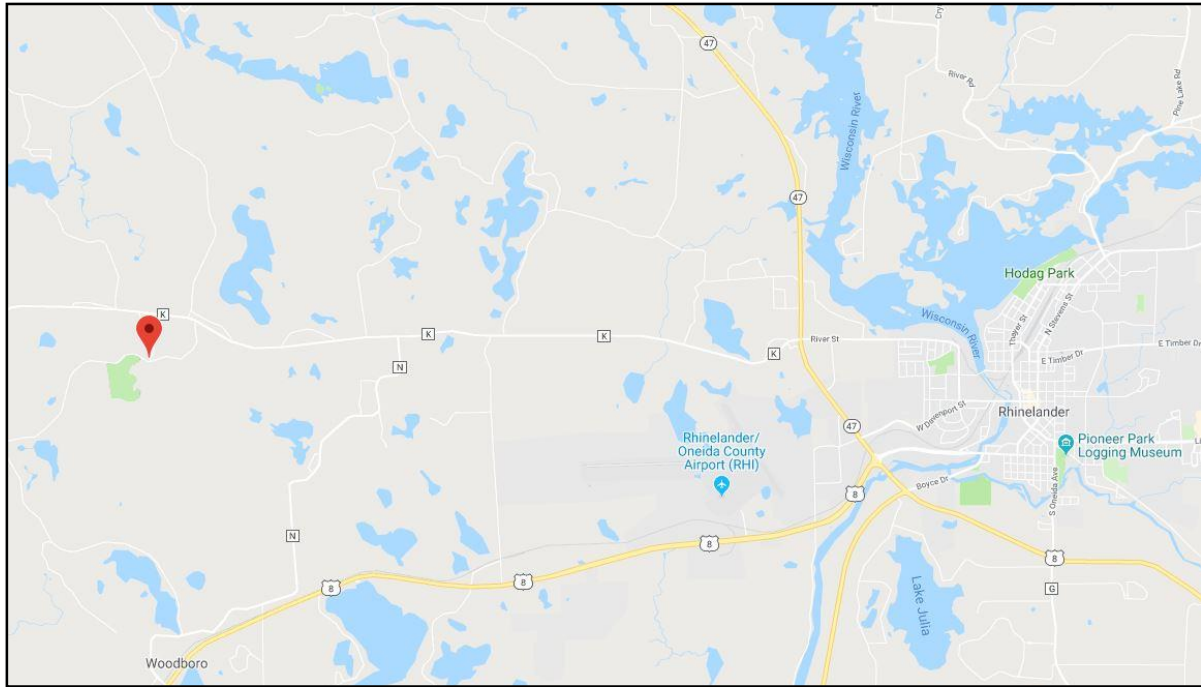

**Figure 2.** Location of Oneida County landfill west of Rhineland, Wisconsin.

Deer Remote Registration Information:

Deer harvested within the tribally-designated CWD management area are required to be registered via GLIFWC’s remote registration phone line: 844-234-5439.

### CWD Testing Information:

Members harvesting deer within a tribally-designated CWD management area are strongly encouraged to submit samples for CWD testing, and refrain from consuming any venison until test results can verify it is free of CWD (usually within 2 weeks).

### Head removal for CWD testing:

Leave about a hand width, or about 5 inches of neck when cutting off the head of a white-tailed deer for CWD testing. Any antlers should be removed from the deer. Double-bag the head in heavy-duty plastic garbage bags and bring to the nearest testing facility within the CWD management area. Be prepared to fill out a CWD sample form. If at a Wisconsin DNR CWD sampling kiosk, fill out the datasheet with your name, contact information, and harvest location. Instead of providing a DNR customer number, write “tribal member” in the comment section. A tracking number will be provided to look up your test results at the website below:

<https://dnr.wi.gov/wmcwd/CWDResults/Search>



CWD barcode used to track deer results

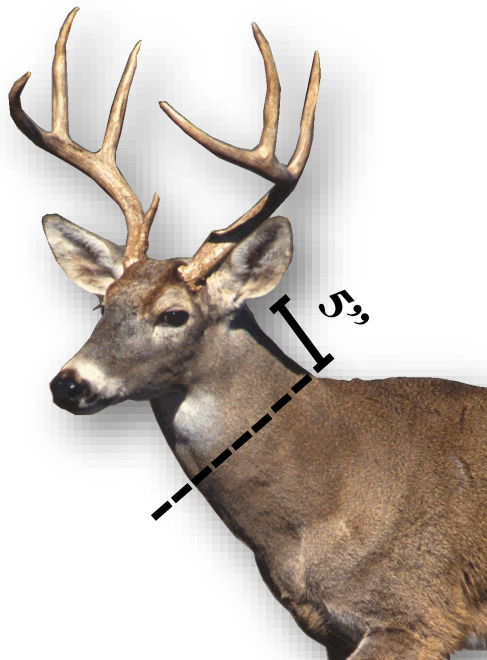



Testing Drop-off Sites within the tribally designated CWD management area (2019):

A CWD sampling database can be found at this website:

<https://dnr.wi.gov/topic/wildlifehabitat/registersample.html>

Wisconsin DNR – Rhinelander Service Center  
107 Sutliff Ave.  
Rhinelander, WI 54501  
Phone: 715-365-8999

Fisher's Bar  
N11209 Hwy 17  
Gleason, WI 54439  
Phone: 608-220-1817

Three Lakes Shell Station  
1742 Superior Street  
Three Lakes, WI 54562  
Phone: 715-365-8999

Summit Lake Gas N Go  
N9521 US-45  
Summit Lake, WI 54428  
Phone: 715-275-3830

Geiss Meat Service  
W4490 Pope Road  
Merrill, WI 54452  
Phone: 715-536-5283

DNR Service Center  
518 W Somo Ave  
Tomahawk, WI 54487  
Phone: 608-220-1817

DNR Service Center  
101 Eagle Drive  
Merrill, WI 54452  
Phone: 608-220-1817

Karl Hofmann Deer Processing  
N9546 Crass Road  
Tomahawk, WI 54487  
Phone: 715-453-3978

More Information:

For more information, contact the Biological Services Division of GLIFWC at (715) 682-6619. Check GLIFWC's website for updated information and additional carcass disposal and testing options as they become available: <https://data.glifwc.org/cwd/>

**B. [Reserved]**

**C. [Reserved]**

**D. [Reserved]**